



# GENSTAX<sup>TM</sup>

Modular Double-Wall Positive Pressure Chimney System. Factory Built for Engine Exhaust



## Specifications

### Applications

GENSTAX is a modular double-wall positive pressure chimney designed for use with engine exhaust.

### Materials and Construction

.035" stainless steel 304 inner wall.  
.018" stainless steel 304 outer wall. Laser weld exterior and interior joint.

Double-wall, 2" insulated chimney.

### Clearances

1" for building heating appliance chimney and 1400°F factory-built chimney.

### Diameters

5" - 10"

### Listings

Tested in accordance with UL 103, UL 1978 ULC/ORD C959, ULC S604, NFPA211, NFPA31, NFPA37, NFPA96, CSA-B149

## UL 103, UL 1978 (DIS), ULC/ORD C959 and ULC S604 System

### GENSTAX™

The GENSTAX venting systems are designed to offer the ultimate in installation convenience and versatility. Certified for engine exhaust applications. Thick-gauge material for the inner pipe and coupling provides a strong and rigid assembly. Self-centering flue design significantly simplifies and accelerates the installation process. Coupling configuration requires only one locking band and the use of a regular, less expensive, high-temperature silicone sealant.

GENSTAX is lined with the highest-quality insulation, densely packed to ensure low heat loss, maximum draft and a 1" clearance to combustible materials.



---

## Table of Contents

Length .....	4
Variable Length .....	4
Bellows Length .....	4
Anchor Plate Length .....	4
15° Elbow .....	5
30° Elbow .....	5
45° Elbow .....	5
45° Elbow Kit .....	6
90° Tees .....	6
90° Tee / Smaller Snout .....	6
45° Tee .....	7
45° Tee / Smaller Snout .....	7
45° Tee Relief Valve .....	7
Drain Tee Cap .....	8
Locking Band .....	8
Tapered Increaser .....	8
ANSI Flange Adapter .....	9
Anchor Plate .....	9
Guy Wire .....	9
Half Angle Ring .....	10
Floor / Ceiling Radiation Shield .....	10
Wall Radiation Shield .....	10
Flashing .....	10
Adjustable Flashing .....	11
Storm Collar .....	11
Finishing Cone .....	11
Flip Top .....	12
Miter Cut .....	12
Relief Valve .....	12

Length

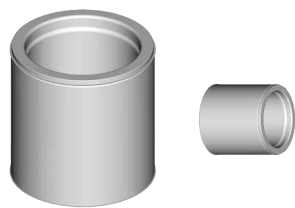

Available in sizes from 5- to 10-inch diameters.

SIZE	LENGTH	12"	18"	24"	36"
Ø 5" - 10"	Effective Length	11 3/8"	17 3/8"	23 3/8"	35 3/8"
	DIS	DISØL12CC	DISØL18CC	DISØL24CC	DISØL36CC

Variable Length

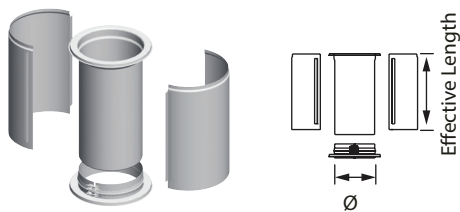

Used to adjust to fit odd dimensions. Not used for thermal expansion. Can be used in positive pressure applications. Locking band included.

SIZE	PRODUCT LINE	ORDER #	EFFECTIVE LENGTH
Ø 5" - 10"	DIS	DISØLVCC	4"-26"

Bellows Length

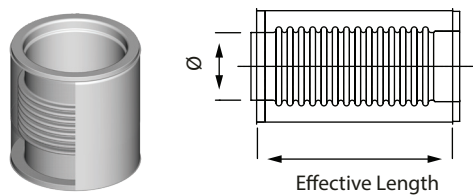

Use to compensate for thermal expansion and to minimize vibration. Has a 3" maximum compression. Locking band and liner included.

SIZE	PRODUCT LINE	ORDER #	EFFECTIVE LENGTH
Ø 5" - 10"	DIS	DISØLBCC	17 3/8"

Anchor Plate Length

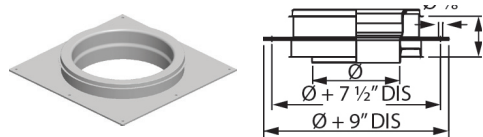

Provides maximal support to vertical sections.

SIZE	PRODUCT LINE	ORDER #
Ø 5" - 10"	DIS	DISØAPLCC

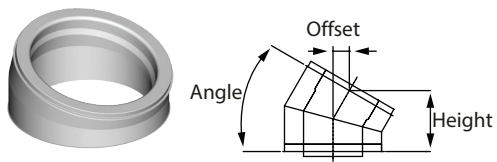
**15° Elbows**

Use to change direction of the stack or to provide offset.

SIZE	ANGLE	OFFSET (in.)	HEIGHT (in.)	DIS
				ORDER #
5"	15°	1 <sup>1</sup> / <sub>16</sub>	5 <sup>7</sup> / <sub>16</sub>	DIS5E15CC
6"	15°	3 <sup>3</sup> / <sub>4</sub>	5 <sup>9</sup> / <sub>16</sub>	DIS6E15CC
8"	15°	3 <sup>3</sup> / <sub>4</sub>	5 <sup>7</sup> / <sub>8</sub>	DIS8E15CC
10"	15°	1 <sup>3</sup> / <sub>16</sub>	6 <sup>1</sup> / <sub>8</sub>	DIS10E15CC

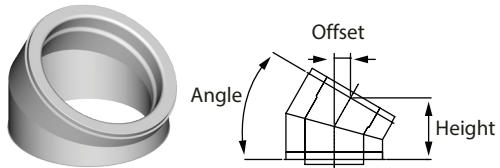
**30° Elbows**

Use to change direction of the stack or to provide offset.

SIZE	ANGLE	OFFSET (in.)	HEIGHT (in.)	DIS
				ORDER #
5"	30°	1 <sup>1</sup> / <sub>16</sub>	6 <sup>5</sup> / <sub>16</sub>	DIS5E30CC
6"	30°	1 <sup>3</sup> / <sub>4</sub>	6 <sup>9</sup> / <sub>16</sub>	DIS6E30CC
8"	30°	1 <sup>7</sup> / <sub>8</sub>	7 <sup>1</sup> / <sub>16</sub>	DIS8E30CC
10"	30°	2	7 <sup>9</sup> / <sub>16</sub>	DIS10E30CC

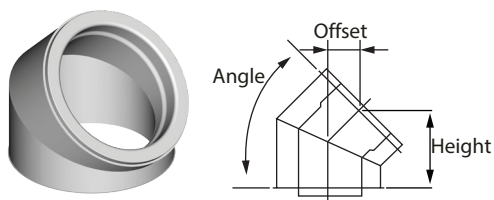
**45° Elbows**

Use to change direction of the stack or to provide offset. Use two 45° elbows to create a 90° offset.

SIZE	ANGLE	OFFSET (in.)	HEIGHT (in.)	DIS
				ORDER #
5"	45°	2 <sup>13</sup> / <sub>16</sub>	6 <sup>15</sup> / <sub>16</sub>	DIS5E45CC
6"	45°	2 <sup>15</sup> / <sub>16</sub>	7 <sup>1</sup> / <sub>4</sub>	DIS6E45CC
8"	45°	3 <sup>1</sup> / <sub>4</sub>	8	DIS8E45CC
10"	45°	3 <sup>9</sup> / <sub>16</sub>	8 <sup>11</sup> / <sub>16</sub>	DIS10E45CC

## 45° Elbow Kit

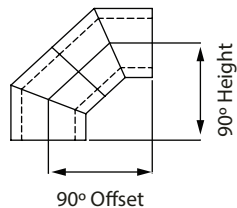

Use two 45° elbows to create a 90° offset.

SIZE	ANGLE	OFFSET (in.)	HEIGHT (in.)	DIS
				ORDER #
5"	90°	9 <sup>23</sup> / <sub>32</sub>	9 <sup>27</sup> / <sub>32</sub>	DIS5EK45CC
6"	90°	10 <sup>5</sup> / <sub>32</sub>	10 <sup>5</sup> / <sub>16</sub>	DIS6EK45CC
8"	90°	11 <sup>7</sup> / <sub>32</sub>	11 <sup>11</sup> / <sub>32</sub>	DIS8EK45CC
10"	90°	12 <sup>7</sup> / <sub>32</sub>	12 <sup>5</sup> / <sub>16</sub>	DIS10EK45CC

## 90° Tees

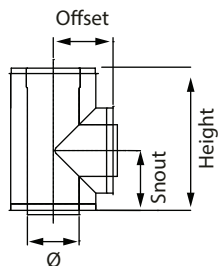

Use to change direction at 90° breeching or inspection access.

SIZE	ANGLE	OFFSET (in.)	HEIGHT (in.)	SNOUT (in.)	DIS
					ORDER #
5"	90°	6 ½	15	6 ½	DIS5T90CC
6"	90°	7	16	7	DIS6T90CC
8"	90°	8	18	8	DIS8T90CC
10"	90°	9	20	9	DIS10T90CC

## 90° Tee / Available w/ Smaller Snout



Use to change direction at 90° breeching or inspection access. Locking band included. Same dimensions as 90° Tees.

SIZE	ANGLE	OFFSET (in.)	HEIGHT (in.)	SNOUT (in.)	DIS
					ORDER #
5"	90°	6 ½	15	6 ½	N/A
6"	90°	7	16	7	DIS6T90B0CC
8"	90°	8	18	8	DIS8T90B0CC
10"	90°	9	20	9	DIS10T90B0CC

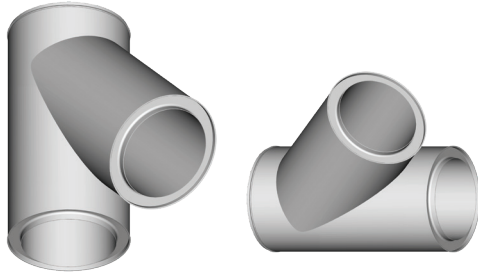
**45° Tee**

Use to change direction at 45° breeching or inspection access.  
Available with a smaller snout. Locking band included.

SIZE	ANGLE	OFFSET (in.)	HEIGHT (in.)	SNOUT (in.)	DIS
					ORDER #
5"	45°	10 <sup>7</sup> / <sub>16</sub>	20 <sup>3</sup> / <sub>8</sub>	4 <sup>3</sup> / <sub>16</sub>	DIS5T45CC
6"	45°	11 <sup>5</sup> / <sub>16</sub>	22 <sup>1</sup> / <sub>16</sub>	4 <sup>11</sup> / <sub>16</sub>	DIS6T45CC
8"	45°	13	24 <sup>7</sup> / <sub>8</sub>	5 <sup>3</sup> / <sub>8</sub>	DIS8T45CC
10"	45°	14 <sup>3</sup> / <sub>4</sub>	27 <sup>11</sup> / <sub>16</sub>	6 <sup>1</sup> / <sub>8</sub>	DIS10T45CC

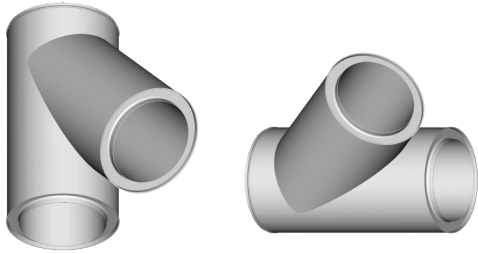
**45° Tee w/ Smaller Snout**

Use to change direction at 45° breeching or inspection access.  
Locking band included. Same dimensions as 45° tees.

SIZE	ANGLE	DIS
		ORDER #
Ø 5" - 10"	45°	DISØT45BØCC

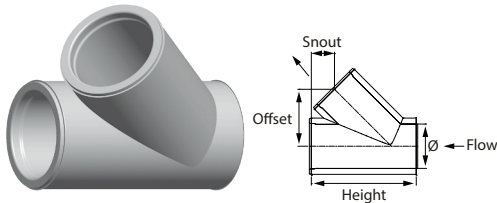
**45° Tee Relief Valve**

Use to combine with the relief valve and female ANSI flange adapter.  
Locking band included. Same dimensions as 45° Tee.

SIZE	PRODUCT LINE	ORDER #
Ø 5" - 10"	DIS	DISØT45RVCC

Drain Tee Cap

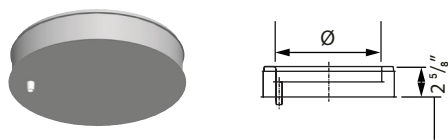

Use to close and seal unused tee ports and to provide drain point for rain or condensation. Locking band included. 1" - NPT

SIZE	PRODUCT LINE	ORDER #
Ø 5" - 10"	DIS	DISØDTCCC

Locking Band

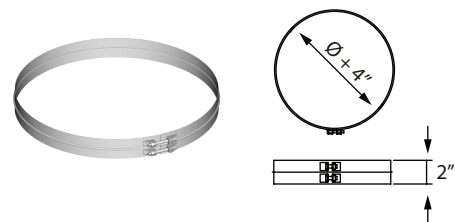

Use to clamp and seal parts together. Included with components that require the locking band.

SIZE	PRODUCT LINE	ORDER #
Ø 5" - 10"	DIS	DISØBSCCC

Tapered Increaser

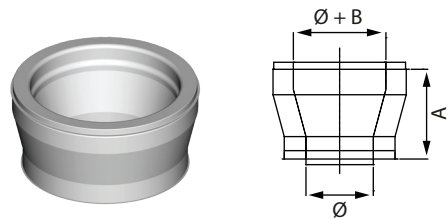

Use when a pipe diameter change is required. Locking band included.

STEP	DIS	A (in.)	B (in.)
	ORDER #		
One Ø 5"-10" Increase	DISØTINS1CC	8	2
Two Ø 5"-10" Increase	DISØTINS2CC	12	4
Three Ø 5"-10" Increase	DISØTINS3CC	16	6



## ANSI Flange Adapter

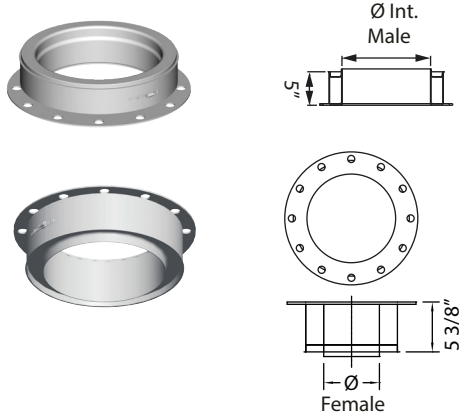

Use for connecting a 125 or 150 lb. ANSI flange. 1/4" thickness with a bolt hole pattern, bolt hole center pattern and quantity per 125-lb ANSI. Locking band included.

SIZE	Ø B (in.)	MALE	FEMALE
		DIS	DIS
		ORDER #	ORDER #
5"	10	DIS5FACC	DIS5FFACC
6"	11	DIS6FACC	DIS6FFACC
8"	13½	DIS8FACC	DIS8FFACC
10"	16	DIS10FACC	DIS10FFACC

## Anchor Plate

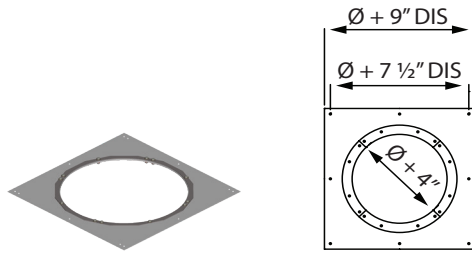

Use for supporting the stack in vertical or horizontal runs and to provide a fixed point for thermal expansion consideration. Maintains a minimum of 1" clearance to the opening on DIS installations. All hardware included except connection to structure. Must not be in contact with combustible.

SIZE	PRODUCT LINE	ORDER #
Ø 5" - 10"	DIS	DIS0APP

## Guy Wire

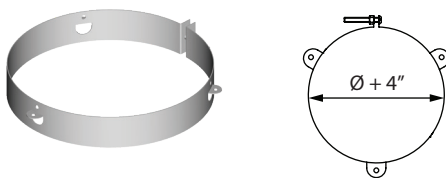

Use for guiding in vertical installation above the roof. All hardware included except wire, tensioner and connection to roof. See instruction manual for required specifications.

SIZE	PRODUCT LINE	ORDER #
Ø 5" - 10"	DIS	DIS0GWE

Half Angle Ring

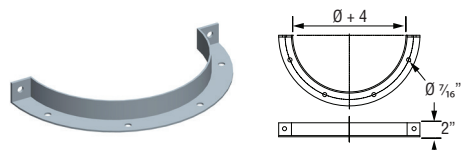

Use for supporting and guiding the stack in horizontal runs. Not recommended for thermal expansion systems. See installation instructions for spacing.

Ø	PRODUCT LINE	ORDER #
Ø 5" to 10"	DIS	DISØHARP

Floor / Ceiling Radiation Shield

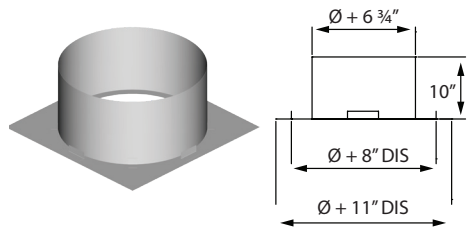

Use where chimney passes through a combustible roof or structure. Maintains a minimum of 2" clearance to the opening on DIS installations.

SIZE	PRODUCT LINE	ORDER #
Ø 5" - 10"	DIS	DISØFSE

Wall Radiation Shield

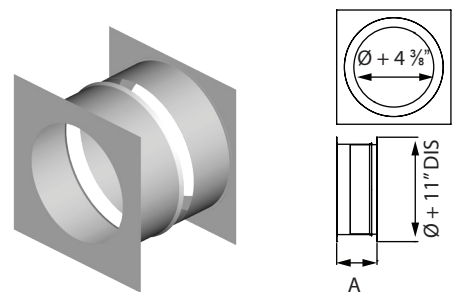

Use where chimney passes through a combustible wall. Maintains a minimum of 2" clearance to the opening on DIS installations.

SIZE	PRODUCT LINE	ORDER #	A
Ø 5" - 10"	DIS	DISØFSWE	7" - 12"

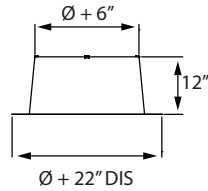
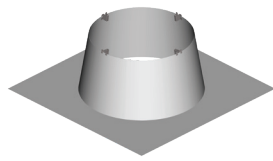
**Flashing**

Use in conjunction with storm collar for weatherization at the roof. Storm collar included.

SIZE	PRODUCT LINE	ORDER #
Ø 5" - 10"	DIS	DISØFC

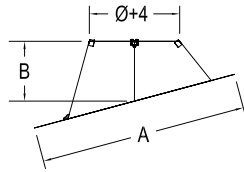
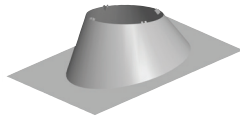
**Adjustable Flashing**

Use in conjunction with storm collar for weatherization at the roof. 5° to 30° pitch.

SIZE	PRODUCT LINE	ORDER #
Ø 5" - 10"	DIS	DISØF30C

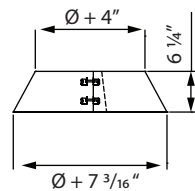
**Storm Collar**

Use above the flashing for complete weatherization above the roof. To be sealed with outer joint sealant (not included).

SIZE	PRODUCT LINE	ORDER #
Ø 5" - 10"	DIS	DISØSCC

Finishing Cone

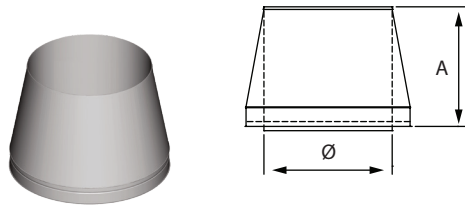

Use to provide the greatest draft. Requires a drain at bottom of stack.

SIZE	PRODUCT LINE	ORDER #	A
Ø 5" - 10"	DIS	DISØFCCC	10"

Flip Top

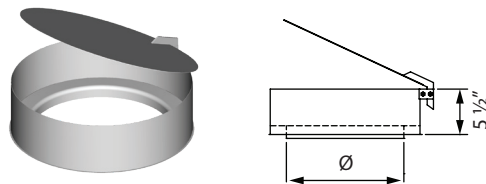

Use to prevent moisture and debris from entering system. Flip top opens with internal pressure and closes when no pressure is present. For engine exhaust application.

SIZE	PRODUCT LINE	ORDER #
Ø 5" - 10"	DIS	DISØFTC

Miter Cut

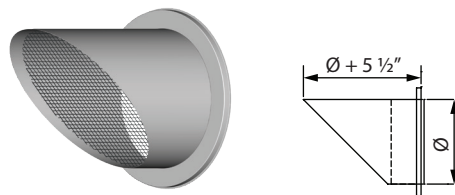

Use for horizontal engine exhaust termination.

SIZE	PRODUCT LINE	ORDER #
Ø 5" - 10"	DIS	DISØMCC

Relief Valve

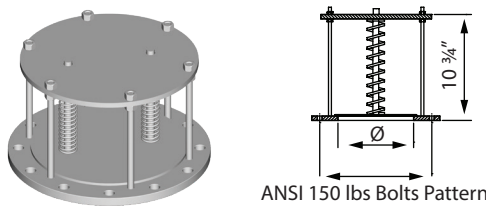

Helps control the venting pressure should a backfire occur. Must be used in conjunction with ANSI flanged adapter and 45° tee relief valve. Use on engine exhaust.

SIZE	PRODUCT LINE	ORDER #
Ø 5" - 10"	DIS	DISØRVC

**GENSTAX 1 YEAR STANDARD AND 15 YEAR LIMITED WARRANTY**

This Duravent 1-year Standard and 15-year Limited Warranty warrants your GENSTAX DIS stainless steel multi-fuel double-wall insulated chimney systems (Product) to be free from defects in material and workmanship at the time of manufacture. This 1-year Standard and 15-year Limited Warranty includes all components and fittings. After installation, if covered components manufactured by Duravent are found to be defective in materials or workmanship during the 1-year Standard and 15-year Warranty period and while the Product remains at the site of the original installation, Duravent will replace the covered components. Duravent reserves the right to replace covered components with an equivalent product and the replacement must be carried out in accordance with Duravent recommendations. If replacement is not commercially practical, Duravent will, at its option, refund the purchase price or wholesale price of the Duravent Product, whichever is applicable. Labor or freight costs to remove or replace Duravent components are not included. THERE ARE EXCLUSIONS AND LIMITATIONS to the 1-year Standard and 15-year Limited Warranty as described herein.

**Coverage Commencement Date**

Warranty coverage begins on the date of shipment from Duravent.

**Exclusions and Limitations**

This 1-year Standard and 15-year Limited Warranty applies only if the Product is installed in the United States or Canada and only if used for the application for which it was designed and intended. The Product must be installed and maintained in accordance with the system design, installation and maintenance instructions for the Product and in compliance with all applicable installation and building codes and high-quality, industry-accepted trade practices. Any repaired or replaced product shall be warranted for the duration of time no longer than the remaining or unexpired term of the original warranty.

The 1-year Standard Warranty is extended to the purchaser subject to the following conditions:

- Generally accepted engineering practices have been followed to determine that sizing and material specifications are suitable for the application and environment involved;
- The components have been correctly installed in accordance with the system design and installation instructions for the Product as provided by Duravent;
- Damage is not a result of burning garbage, waste oil, #6 oil or any other inappropriate or prohibited material in the appliance served by the venting system.

The Extended 15-year Limited Warranty is extended to the purchaser subject to the following additional conditions:

- The design parameters provided to Duravent by the responsible engineer at the time of design were and are accurately representative of the operating conditions;
- The system sizing and design was performed or approved by Duravent;
- The engine exhaust is and has operated free of solvent or refrigerant vapors or any halogenated compound which may cause acid condensates to form within the chimney system;
- The entire exhaust system was supplied by Duravent;
- Exposed Galvalume and galvanized surfaces are protected with a minimum of one base coat of primer and one finish coat of heat resistant and corrosive-resistant paint at all times. Stainless steel surfaces do not require painting.

This warranty is non-transferable and extends to the original owner only. The Product must be purchased through an Duravent Agent/Representative and proof of purchase must be provided.

Duravent will not be responsible for: (a) damages caused by normal wear and tear, corrosion from salt air, accident, riot, fire, flood or acts of God; (b) damages caused by abuse, negligence, misuse, or unauthorized alteration or repair of the Product affecting its stability or performance; (c) damages caused by failing to provide proper maintenance and service in accordance with the design, installation and maintenance instructions for the Product; (d) damages, repairs or inefficiency resulting from faulty installation or application of the Product.

This 1-year Standard and 15-year Limited Warranty covers only parts as provided herein. Duravent's entire liability is limited to the purchase price of this Product. In no case shall Duravent be responsible for materials, components or construction that are not manufactured or supplied by Duravent or for the labor necessary to install, repair or remove such materials, components or construction. All replacement or repair components will be shipped F.O.B. from the Duravent manufacturing facility.

**Limitation on Liability**

It is expressly agreed and understood that the sole obligation of Duravent and the purchaser's exclusive remedy under this warranty, under any other warranty, expressed or implied, or in contract, tort or otherwise, shall be limited to replacement, repair, or refund, as specified herein. In no event shall Duravent be liable for any incidental or consequential damages caused by defects in the Product, whether such damage occurs or is discovered before or after replacement or repair, and whether such damage is caused by Duravent negligence. Duravent makes no expressed warranties except as stated in this 1-year Standard and 15-year Limited Warranty. The duration of any implied warranty is limited to the duration of this expressed warranty. No one is authorized to change this 1-year Standard and 15-year Limited Warranty or to create for Duravent any other obligation or liability in connection with the Product. Some states and provinces do not allow the exclusion or limitation of incidental or consequential damages, so the above limitations or exclusions may not apply to you. The provisions of this 1-year Standard and 15-year Limited Warranty are in addition to and not a modification of or subtraction from any statutory warranties and other rights and remedies provided by law.

**Investigation of Claims Against Warranty**

Duravent reserves the right to investigate any and all claims against this 1-year Standard and 15-year Limited Warranty and to decide, in its sole discretion, upon the method of settlement. Duravent shall in no event be responsible for any warranty work done by a contractor who is not approved without first obtaining Duravent's prior written consent.

Manufactured in Laval, Quebec

[illegible]



BUILD FOR THE FUTURE

Customer Service and Support:

Airmate (USA).....	800.992.8368
Airmate (CAN).....	888.735.5475
Ameriflow.....	800.252.8467
Amerivent (Retail).....	800.252.8467
Amerivent (Hearth & Wholesale) ....	800.423.4270
Amerivent (Support).....	800.748.0392
AMPCO (USA) .....	800.669.3269
AMPCO (CAN).....	888.735.5475
Duravent.....	800.835.4429
Hart & Cooley.....	800.433.6341
Hart & Cooley (Support).....	800.748.0392
Heatfab (USA).....	800.772.0739
Heatfab (CAN) .....	800.848.2149
Lima.....	800.423.4270
Milcor.....	800.774.5240
Portals Plus.....	800.774.5240
RPS.....	800.624.8642
Security Chimney (USA).....	800.361.4909
Security Chimney (CAN) .....	800.667.3387
Selkirk (USA) Residential.....	800.992.8368
Selkirk (USA) Commercial.....	800.848.2149
Selkirk (USA) Support.....	800.748.0392
Selkirk (CAN).....	888.735.5475

Manufacturing & Distribution Centers:

CANADA	
Nobel, ON	Manufacturing
Laval, QC	Manufacturing
Prescott, ON	Distribution
USA	
Grand Rapids, MI	Center of Excellence
Dallas, TX	Distribution
Englewood, OH	Distribution
Huntsville, AL	Manufacturing & Distribution
Mira Loma, CA	Distribution
Nampa, ID	Manufacturing & Distribution
Turner Falls, MA	Manufacturing & Distribution
Vacaville, CA	Manufacturing
MEXICO	
Ojinaga, MX	Manufacturing
Mexicali, MX	Manufacturing

Corporate Headquarters:

Duravent Group  
28 W. Adams, Suite 1810  
Detroit, MI 48226  
Tel: 800.835.4429  
Email: [info@duraventgroup.com](mailto:info@duraventgroup.com)  
[www.duraventgroup.com](http://www.duraventgroup.com)



BUILD FOR THE FUTURE

[www.duraventgroup.com](http://www.duraventgroup.com)

